

# Notice of variation and consolidation with introductory note

**The Environmental Permitting (England & Wales) Regulations 2016**

---

J. Dickinson and Sons (Horwich) Limited

The Materials Recycling Facility  
Rivington View Business Park  
Station Road  
Blackrod, Bolton  
BL6 5GR

**Variation application number**

EPR/EP3497CA/V007

**Permit number**

EPR/EP3497CA

# The Materials Recycling Facility

## Permit number EPR/EP3497CA

### Introductory note

#### This introductory note does not form a part of the notice

Under the Environmental Permitting (England & Wales) Regulations 2016 (schedule 5, part 1, paragraph 19) a variation may comprise a consolidated permit reflecting the variations and a notice specifying the variations included in that consolidated permit.

Schedule 1 of the notice specifies the conditions that have been varied and schedule 2 comprises a consolidated permit which reflects the variations being made. All the conditions of the permit have been varied and are subject to the right of appeal.

The consolidated variation notice will increase the annual throughput of aggregate and soil processing from 75,000tpa to 275,000tpa. A consolidated notice has been issued to reflect current site activities. Composting, vehicle depollution and mechanical biological treatment activities are not currently undertaken on the site. A pre-operational condition for future development has been written into this permit to ensure that relevant updates to management plans are made prior to these activities recommencing.

The schedules specify the changes made to the permit.

The status log of a permit sets out the permitting history, including any changes to the permit reference number.

Status log of the permit		
Description	Date	Comments
Permit determined EAWML 54330	09/02/2001	Original permit issued to J. Dickinson & Sons (Horwich) Limited
Permit Modified EAWML 54330	11/12/2003	Add treatment activities
Permit Modified EAWML 54330	09/04/2008	Modification of licence
Variation determined EPR/EP3497CA/V004 (EAWML 54330)	21/05/2012	Variation to add standard rules permit (SR2010 No12)
Variation determined EPR/EP3497CA/V005	07/06/2013	Application to add waste codes
Variation determined EPR/EP3497CA/V006	02/12/2013	Agency led variation to update pest condition
Application EPR/EP3497CA/V007 (variation and consolidation)	Duly made 30/07/2020	Application to vary and update the permit to modern conditions.
Variation determined and consolidation issued EPR/EP3497CA	01/11/2020	Varied and consolidated permit issued in modern format

End of introductory note

# Notice of variation and consolidation

## The Environmental Permitting (England and Wales) Regulations 2016

The Environment Agency in exercise of its powers under regulation 20 of the Environmental Permitting (England and Wales) Regulations 2016 varies

### Permit number

EPR/EP3497CA

### Issued to

**J. Dickinson and Sons (Horwich) Limited** (“the operator”)

whose registered office is

**Unit 5 Rivington View**

**Horwich, Bolton**

**United Kingdom**

**BL6 5BN**

company registration number 00351057

to operate a regulated facility at

**The Materials Recycling Facility**

**Rivington View Business Park**

**Station Road**

**Blackrod, Bolton**

**BL6 5GR**

to the extent set out in the schedules.

The notice shall take effect from 01/11/2020

Name	Date
Tracey Pollard	01/11/2020

Authorised on behalf of the Environment Agency

## **Schedule 1**

All conditions have been varied by the consolidated permit as a result of the application made by the operator.

## **Schedule 2 – consolidated permit**

Consolidated permit issued as a separate document.

# Permit

## The Environmental Permitting (England and Wales) Regulations 2016

### Permit number

**EPR/EP3497CA**

This is the consolidated permit referred to in the variation and consolidation notice for application EPR/EP3497CA/V007 authorising,

**J. Dickinson and Sons (Horwich) Limited** (“the operator”),

whose registered office is

**Unit 5 Rivington View**

**Horwich, Bolton**

**United Kingdom**

**BL6 5BN**

company registration number 00351057

to operate waste operations at

**The Materials Recycling Facility**

**Rivington View Business Park**

**Station Road**

**Blackrod, Bolton**

**BL6 5GR**

to the extent authorised by and subject to the conditions of this permit.

<b>Name</b>	<b>Date</b>
<b>Tracey Pollard</b>	<b>01/11/2020</b>

Authorised on behalf of the Environment Agency

# Conditions

## 1 Management

### 1.1 General management

- 1.1.1 The operator shall manage and operate the activities:
- (a) in accordance with a written management system that identifies and minimises risks of pollution, including those arising from operations, maintenance, accidents, incidents, non-conformances, closure and those drawn to the attention of the operator as a result of complaints; and
  - (b) using sufficient competent persons and resources.
- 1.1.2 Records demonstrating compliance with condition 1.1.1 shall be maintained.
- 1.1.3 Any person having duties that are or may be affected by the matters set out in this permit shall have convenient access to a copy of it kept at or near the place where those duties are carried out.
- 1.1.4 The operator shall comply with the requirements of an approved competence scheme.

### 1.2 Avoidance, recovery and disposal of wastes produced by the activities

- 1.2.1 The operator shall take appropriate measures to ensure that:
- (a) the waste hierarchy referred to in Article 4 of the Waste Framework Directive is applied to the generation of waste by the activities; and
  - (b) any waste generated by the activities is treated in accordance with the waste hierarchy referred to in Article 4 of the Waste Framework Directive; and
  - (c) where disposal is necessary, this is undertaken in a manner which minimises its impact on the environment.
- 1.2.2 The operator shall review and record at least every four years whether changes to those measures should be made and take any further appropriate measures identified by a review.

## 2 Operations

### 2.1 Permitted activities

- 2.1.1 The operator is only authorised to carry out the activities specified in schedule 1 table S1.1 (the “activities”).

### 2.2 The site

- 2.2.1 The activities shall not extend beyond the site, being the land shown edged in green on the site plan at schedule 7 to this permit.

### 2.3 Operating techniques

- 2.3.1 The activities shall, subject to the conditions of this permit, be operated using the techniques and in the manner described in the documentation specified in schedule 1, table S1.2, unless otherwise agreed in writing by the Environment Agency.

2.3.2 If notified by the Environment Agency that the activities are giving rise to pollution, the operator shall submit to the Environment Agency for approval within the period specified, a revision of any plan or other documentation (“plan”) specified in schedule 1, table S1.2 or otherwise required under this permit which identifies and minimises the risks of pollution relevant to that plan, and shall implement the approved revised plan in place of the original from the date of approval, unless otherwise agreed in writing by the Environment Agency.

2.3.3 Waste shall only be accepted if:

- (a) it is of a type and quantity listed in schedule 2 tables S2.1, S2.2, S2.3, S2.4; and
- (b) it conforms to the description in the documentation supplied by the producer and holder.

## **2.4 Pre-operational conditions**

2.4.1 The operations specified in schedule 1 table S1.3 shall not commence until the measures specified in that table have been completed.

## **2.5 Technical requirements**

### **Hazardous waste storage and treatment**

2.5.1 Hazardous waste shall not be mixed, either with a different category of hazardous waste or with other waste, substances or materials, unless it is authorised by schedule 1 table S1.1 and appropriate measures are taken.

## **3 Emissions and monitoring**

### **3.1 Emissions to water, air or land**

3.1.1 There shall be no point source emissions to water, air or land except from the sources and emission points listed in schedule 3 tables S3.1 and S3.2.

3.1.2 The limits given in schedule 3 shall not be exceeded.

### **3.2 Emissions of substances not controlled by emission limits**

3.2.1 Emissions of substances not controlled by emission limits (excluding odour) shall not cause pollution. The operator shall not be taken to have breached this condition if appropriate measures, including, but not limited to, those specified in any approved emissions management plan, have been taken to prevent or where that is not practicable, to minimise, those emissions.

3.2.2 The operator shall:

- (a) if notified by the Environment Agency that the activities are giving rise to pollution, submit to the Environment Agency for approval within the period specified, an emissions management plan which identifies and minimises the risks of pollution from emissions of substances not controlled by emission limits;
- (b) implement the approved emissions management plan, from the date of approval, unless otherwise agreed in writing by the Environment Agency.

3.2.3 All liquids in containers, whose emission to water or land could cause pollution, shall be provided with secondary containment, unless the operator has used other appropriate measures to prevent or where that is not practicable, to minimise, leakage and spillage from the primary container.

### **3.3 Monitoring**

- 3.3.1 The operator shall, unless otherwise agreed in writing by the Environment Agency, undertake the monitoring specified in the following tables in schedule 3 to this permit:
- (a) point source emissions specified in tables S3.1;
  - (b) ambient air monitoring specified in table S3.2;
- 3.3.2 The operator shall maintain records of all monitoring required by this permit including records of the taking and analysis of samples, instrument measurements (periodic and continual), calibrations, examinations, tests and surveys and any assessment or evaluation made on the basis of such data.
- 3.3.3 Monitoring equipment, techniques, personnel and organisations employed for the emissions monitoring programme and the environmental or other monitoring specified in condition 3.3.1 shall have either MCERTS certification or MCERTS accreditation (as appropriate), where available, unless otherwise agreed in writing by the Environment Agency.
- 3.3.4 Permanent means of access shall be provided to enable sampling/monitoring to be carried out in relation to the emission points specified in schedule 3 tables S3.1, S3.2 unless otherwise agreed in writing by the Environment Agency.

### **3.4 Odour**

- 3.4.1 Emissions from the activities shall be free from odour at levels likely to cause pollution outside the site, as perceived by an authorised officer of the Environment Agency, unless the operator has used appropriate measures, including, but not limited to, those specified in any approved odour management plan, to prevent or where that is not practicable to minimise the odour.

### **3.5 Noise and vibration**

- 3.5.1 Emissions from the activities shall be free from noise and vibration at levels likely to cause pollution outside the site, as perceived by an authorised officer of the Environment Agency, unless the operator has used appropriate measures, including, but not limited to, those specified in any approved noise and vibration management plan to prevent or where that is not practicable to minimise the noise and vibration.
- 3.5.2 The operator shall:
- (a) if notified by the Environment Agency, submit to the Environment Agency for approval within the period specified, a noise management plan which identifies and minimises risks of pollution, hazard or annoyance from pests;
  - (b) implement the noise management plan, from the date of approval, unless otherwise agreed in writing by the Environment Agency.

### **3.6 Pests**

- 3.6.1 The activities shall not give rise to the presence of pests which are likely to cause pollution, hazard or annoyance outside the boundary of the site. The operator shall not be taken to have breached this condition if appropriate measures, including, but not limited to, those specified in any approved pests management plan, have been taken to prevent or where that is not practicable, to minimise the presence of pests on the site.

### **3.7 Fire prevention**

- 3.7.1 The operator shall take all appropriate measures to prevent fires on site and minimise the risk of pollution from them including, but not limited to, those specified in any approved fire prevention plan.
- 3.7.2 The operator shall:



- (a) if notified by the Environment Agency that the activities are giving rise to a risk of fire, submit to the Environment Agency for approval within the period specified, a fire prevention plan which prevents fires and minimises the risk of pollution from fires;
- (b) implement the fire prevention plan, from the date of approval, unless otherwise agreed in writing by the Environment Agency.

## **4 Information**

### **4.1 Records**

4.1.1 All records required to be made by this permit shall:

- (a) be legible;
- (b) be made as soon as reasonably practicable;
- (c) if amended, be amended in such a way that the original and any subsequent amendments remain legible, or are capable of retrieval; and
- (d) be retained, unless otherwise agreed in writing by the Environment Agency, for at least 6 years from the date when the records were made, or in the case of the following records until permit surrender:
  - (i) off-site environmental effects; and
  - (ii) matters which affect the condition of the land and groundwater.

4.1.2 The operator shall keep on site all records, plans and the management system required to be maintained by this permit, unless otherwise agreed in writing by the Environment Agency.

### **4.2 Reporting**

4.2.1 The operator shall send all reports and notifications required by the permit to the Environment Agency using the contact details supplied in writing by the Environment Agency.

4.2.2 Within one month of the end of each quarter, the operator shall submit to the Environment Agency using the form made available for the purpose, the information specified on the form relating to the site and the waste accepted and removed from it during the previous quarter.

4.2.3 Within 28 days of the end of the reporting period the operator shall, unless otherwise agreed in writing by the Environment Agency, submit reports of the monitoring and assessment carried out in accordance with the conditions of this permit, as follows:

- (a) in respect of the parameters and emission points specified in schedule 4 table S4.1;
- (b) for the reporting periods specified in schedule 4 table S4.1 and using the forms specified in schedule 4 table S4.4 ; and
- (c) giving the information from such results and assessments as may be required by the forms specified in those tables.

### **4.3 Notifications**

4.3.1 The Environment Agency shall be notified without delay following the detection of:

- (a) any malfunction, breakdown or failure of equipment or techniques, accident, or emission of a substance not controlled by an emission limit which has caused, is causing or may cause significant pollution;
- (b) the breach of a limit specified in the permit; or

(c) any significant adverse environmental effects.

4.3.2 Any information provided under condition 4.3.1 shall be confirmed by sending the information listed in schedule 5 to this permit within the time period specified in that schedule.

4.3.3 Where the Environment Agency has requested in writing that it shall be notified when the operator is to undertake monitoring and/or spot sampling, the operator shall inform the Environment Agency when the relevant monitoring and/or spot sampling is to take place. The operator shall provide this information to the Environment Agency at least 14 days before the date the monitoring is to be undertaken.

4.3.4 The Environment Agency shall be notified within 14 days of the occurrence of the following matters, except where such disclosure is prohibited by Stock Exchange rules:

Where the operator is a registered company:

- (a) any change in the operator's trading name, registered name or registered office address; and
- (b) any steps taken with a view to the operator going into administration, entering into a company voluntary arrangement or being wound up.

Where the operator is a corporate body other than a registered company:

- (a) any change in the operator's name or address; and
- (b) any steps taken with a view to the dissolution of the operator.

In any other case:

- (a) the death of any of the named operators (where the operator consists of more than one named individual);
- (b) any change in the operator's name(s) or address(es); and
- (c) any steps taken with a view to the operator, or any one of them, going into bankruptcy, entering into a composition or arrangement with creditors, or, in the case of them being in a partnership, dissolving the partnership.

4.3.5 Where the operator proposes to make a change in the nature or functioning, or an extension of the activities, which may have consequences for the environment and the change is not otherwise the subject of an application for approval under the Regulations or this permit:

- (a) the Environment Agency shall be notified at least 14 days before making the change; and
- (b) the notification shall contain a description of the proposed change in operation.

## **4.4 Interpretation**

4.4.1 In this permit the expressions listed in schedule 6 shall have the meaning given in that schedule.

4.4.2 In this permit references to reports and notifications mean written reports and notifications, except where reference is made to notification being made "without delay", in which case it may be provided by telephone.

# Schedule 1 – Operations

Table S1.1 activities	
Description of activities for waste operations	Limits of activities
<b>All activities</b>	Subject to any other requirements of this permit all permitted wastes shall be stored for no longer than 1 year prior to disposal or 3 years prior to recovery.
<p><b>[A1] – Aggregate and soil treatment facility</b></p> <p>R5: Recycling/reclamation of other inorganic materials</p> <p>R13: Storage of waste pending any of the operations numbered R1 to R12 (excluding temporary storage, pending collection, on the site where the waste is produced)</p>	<p>Physical treatment including manual and mechanical sorting, screening, crushing and blending of non-hazardous waste for recovery.</p> <p>Waste types as specified in Table S2.1</p>
<p><b>[A2] - Waste Transfer Station</b></p> <p>D15: Storage pending any of the operations numbered D1 to D14 (excluding temporary storage, pending collection, on the site where the waste is produced)</p> <p>R13: Storage of waste pending any of the operations numbered R1 to R12 (excluding temporary storage, pending collection, on the site where the waste is produced)</p> <p>D14: Repackaging prior to submission to any of the operations numbered D1 to D13.</p> <p>D9: Physico-chemical treatment not specified elsewhere which results in final compounds or mixtures which are discarded by means of any of the operations numbered D1 to D12</p> <p>R3: Recycling/reclamation of organic substances which are not used as solvents (including composting and other biological transformation processes)</p> <p>R4: Recycling/reclamation of metals and metal compounds</p> <p>R5: Recycling/reclamation of other inorganic materials</p>	<p>Physical treatment including manual and mechanical sorting/ separation, screening, shredding...etc of non-hazardous waste for disposal (no more than 50 tonnes per day) or recovery.</p> <p>Subject to the other provisions of the permit the maximum quantity of hazardous waste received at the site shall not exceed 10 tonnes per day.</p> <p>Temporary storage of hazardous waste shall not exceed 50 tonnes pending any of the activities listed in Part A (1) Section 5.1, 5.2, 5.3 of the EP Regulations.</p> <p>Waste types as specified in Table S2.2</p> <p>All bulking or transfer of non-hazardous waste must be carried out inside a building.</p> <p>Non-hazardous wastes must be kept in a building or within a secure container.</p> <p>Asbestos waste must be double bagged and kept within clearly identified, secure lockable containers. No treatment of asbestos waste is allowed on site.</p> <p>Hazardous and non-hazardous waste must be kept on an impermeable surface with sealed drainage.</p> <p>Inert waste must be kept on hard standing or an impermeable surface with sealed drainage.</p>

<b>Table S1.1 activities</b>	
<b>Description of activities for waste operations</b>	<b>Limits of activities</b>
<p><b>[A3] - Composting</b></p> <p>R13: Storage of waste pending any of the operations numbered R1 to R12 (excluding temporary storage, pending collection, on the site where the waste is produced)</p> <p>R3: Recycling/reclamation of organic substances which are not used as solvents (including composting and other biological transformation processes)</p>	<p>Physical treatment and composting including sanitisation, stabilisation and maturation of non-hazardous wastes as specified in Table S2.3</p> <p>The capacity of the site for non-hazardous waste subject to an R3 activity (Biological treatment only) shall not exceed 75 tonnes per day.</p> <p>All treatment must take place in a well-ventilated building on an impermeable surface with a sealed drainage system, or outdoors on areas of impermeable surface with a sealed drainage system.</p> <p>Treatment must be undertaken in any form of enclosed reactor vessel.</p>
<p><b>[A4] - Vehicle depollution and dismantling facility</b></p> <p>R13: Storage of waste pending any of the operations numbered R1 to R12 (excluding temporary storage, pending collection, on the site where the waste is produced)</p> <p>R4: Recycling/reclamation of metals and metal compounds</p> <p>R5: Recycling/reclamation of other inorganic materials</p> <p>D15: Storage pending any of the operations numbered D1 to D14 (excluding temporary storage, pending collection, on the site where the waste is produced)</p> <p>D14: Repackaging prior to submission to any of the operations numbered D1 to D13.</p>	<p>Treatment consisting only of depollution of waste motor vehicles and sorting, separation, grading, bailing, shearing, compacting, crushing or cutting of waste into different components for recovery.</p> <p>There shall be no treatment of lead acid batteries, other than sorting and separating from other wastes.</p> <p>All batteries shall be stored in containers with an impermeable, acid resistance base and a lid to prevent ingress of surface water.</p> <p>The maximum quantity of hazardous waste treated for disposal or recovery shall not exceed 10 tonnes per day. This does not include the manual depollution and dismantling of waste motor vehicles.</p> <p>Temporary storage of hazardous waste shall not exceed 50 tonnes pending any of the activities listed in Part A (1) Section 5.1, 5.2, 5.3 of the EP Regulations.</p> <p>Waste types as specified in Table S2.4</p> <p>Uncontaminated plastic, glass and ferrous and non-ferrous metal wastes arising from the treatment of end-of-life vehicles must be stored on hardstanding or an impermeable surface with sealed drainage system. All other waste must be stored on an impermeable surface with sealed drainage system.</p>

<b>Table S1.1 activities</b>	
<b>Description of activities for waste operations</b>	<b>Limits of activities</b>
	<p>Waste motor vehicles shall have their tyres removed before they are baled, crushed or compacted.</p> <p>All waste treatment including that of waste motor vehicles must take place on an impermeable surface with sealed drainage system.</p>
<p><b>[A5] - Mechanical-biological treatment of non-hazardous waste</b></p> <p>R3: Recycling/reclamation of organic substances which are not used as solvents (including composting and other biological transformation processes)</p> <p>R4: Recycling/reclamation of metals and metal compounds</p> <p>R5: Recycling/reclamation of other inorganic materials</p> <p>R13: Storage of waste pending any of the operations numbered R1 to R12 (excluding temporary storage, pending collection, on the site where the waste is produced)</p> <p>D9: Physico-chemical treatment not specified elsewhere which results in final compounds or mixtures which are discarded by means of any of the operations numbered D1 to D12</p>	<p>Treatment limited to heat treatment for the purposes of recovery. Physical treatment including screening, crushing, bailing, shredding and pelletising for the purposes of disposal (no more than 50 tonnes per day) or recovery.</p> <p>Waste types as specified in Table S2.5</p> <p>Waste shall be stored within a building provided with an impermeable surface and sealed drainage.</p> <p>Maximum time of waste storage prior to treatment shall not exceed 48 hrs.</p> <p>Waste post treatment must be kept in a building or within a secure container.</p> <p>Waste shall not be treated until background bio-aerosol monitoring has been completed and trigger levels have been agreed in writing with the Environment Agency.</p> <p>Waste shall not be treated until background bio aerosol monitoring has been completed and trigger levels have been agreed in writing with the Environment Agency.</p>

<b>Table S1.2 Operating techniques</b>		
<b>Description</b>	<b>Parts</b>	<b>Date Received</b>
Management Plan	Pest management plan, Report No 12602/2, Version 4 November 2013	27/11/2013
Management Plan	Odour management plan, Version 8A, October 2015	October 2015
Management Plan	Emissions management plan, Report No 12602/4, Version 1, March 2020	19/03/2020

<b>Table S1.3 Pre-operational measures for future development</b>		
<b>Reference</b>	<b>Operation</b>	<b>Pre-operational measures</b>
PO1	Activities A3, A4 and A5 as referenced in Schedule 1, Table S1.1.	Prior to the commencement of activities on site the operator shall submit to the Environment Agency for their approval a revision of the environmental management systems and where relevant revisions to amenity management plans.
PO2	Monitoring as referenced in Schedule 3, Table S3.1 and S3.2.	Prior to the commencement of activities referenced in PO1 the applicant must submit to the Environment Agency for their approval an environmental monitoring plan setting out monitoring parameters, locations, frequency and testing standards.

## Schedule 2 – Waste types

<b>Table S2.1 Permitted waste types and quantities for aggregate and soil treatment facility</b>	
<b>Maximum quantity</b>	The total quantity of waste accepted at the site for the above activity shall be less than 275,000 tonnes a year. Wastes having any of the following characteristics shall not be accepted: <ul style="list-style-type: none"> <li>• Consisting solely or mainly of dusts, powders or loose fibres</li> <li>• Hazardous wastes</li> <li>• Wastes in liquid form</li> </ul>
<b>Waste code</b>	<b>Description</b>
<b>01</b>	<b>Wastes resulting from exploration, mining, quarrying, and physical and chemical treatment of minerals</b>
<b>01 04</b>	<b>wastes from physical and chemical processing of non-metalliferous minerals</b>
01 04 08	waste gravel and crushed rocks other than those mentioned in 01 04 07
01 04 09	waste sand and clays
<b>02</b>	<b>Wastes from agriculture, horticulture, aquaculture, forestry, hunting and fishing, food preparation and processing</b>
<b>02 02</b>	<b>wastes from the preparation and processing of meat, fish and other foods of animal origin</b>
02 02 02	shellfish shells from which the soft tissue or flesh has been removed only
<b>03</b>	<b>Wastes from wood processing and the production of panels and furniture, pulp, paper and cardboard</b>
<b>03 01</b>	<b>wastes from wood processing and the production of panels and furniture</b>
03 01 01	waste bark and cork
<b>03 03</b>	<b>wastes from pulp, paper and cardboard production and processing</b>
03 03 01	waste bark and wood
<b>10</b>	<b>Wastes from thermal processes</b>
<b>10 01</b>	<b>wastes from power stations and other combustion plants (except 19)</b>
10 01 01	bottom ash, slag and boiler dust (excluding boiler dust mentioned in 10 01 04)
10 01 02	coal fly ash
10 01 05	gypsum (solid) only
10 01 07	gypsum (sludge) only
10 01 15	bottom ash, slag and boiler dust from co-incineration other than those mentioned in 10 01 14
<b>10 11</b>	<b>wastes from manufacture of glass and glass products</b>
10 11 12	clean glass other than those mentioned in 10 11 11
<b>10 12</b>	<b>wastes from manufacture of ceramic goods, bricks, tiles and construction products</b>
10 12 08	waste ceramics, bricks, tiles and construction products (after thermal processing)
<b>10 13</b>	<b>wastes from manufacture of cement, lime and plaster and articles and products made from them</b>
10 13 14	waste concrete only
<b>15</b>	<b>Waste packaging, absorbents, wiping cloths, filter materials and protective clothing not otherwise specified</b>

<b>Table S2.1 Permitted waste types and quantities for aggregate and soil treatment facility</b>	
<b>Maximum quantity</b>	The total quantity of waste accepted at the site for the above activity shall be less than 275,000 tonnes a year. Wastes having any of the following characteristics shall not be accepted: <ul style="list-style-type: none"> <li>• Consisting solely or mainly of dusts, powders or loose fibres</li> <li>• Hazardous wastes</li> <li>• Wastes in liquid form</li> </ul>
<b>Waste code</b>	<b>Description</b>
<b>15 01</b>	<b>packaging (including separately collected municipal packaging waste)</b>
15 01 07	clean glass only
<b>17</b>	<b>Construction and demolition wastes (including excavated soil from contaminated sites)</b>
<b>17 01</b>	<b>concrete, bricks, tiles and ceramics</b>
17 01 01	concrete
17 01 02	bricks
17 01 03	tiles and ceramics
17 01 07	mixtures of concrete, bricks, tiles and ceramics other than those mentioned in 17 01 06
<b>17 02</b>	<b>wood, glass and plastic</b>
17 02 02	clean glass only
<b>17 03</b>	<b>bituminous mixtures, coal tar and tarred products</b>
17 03 02	road base and road planings (other than those containing coal tar) only
<b>17 05</b>	<b>soil (including excavated soil from contaminated sites), stones and dredging spoil</b>
17 05 04	soil and stones other than those mentioned in 17 05 03
17 05 06	dredging spoil other than those mentioned in 17 05 05
17 05 08	track ballast other than those mentioned in 17 05 07
<b>17 08</b>	<b>gypsum-based construction material</b>
17 08 02	gypsum-based construction materials other than those mentioned in 17 08 01
<b>19</b>	<b>Wastes from waste management facilities, off-site waste water treatment plants and the preparation of water intended for human consumption and water for industrial use</b>
<b>19 05</b>	<b>wastes from aerobic treatment of solid wastes</b>
19 05 03	compost from source segregated biodegradable waste only
<b>19 08</b>	<b>wastes from waste water treatment plants not otherwise specified</b>
19 08 02	waste from desanding
19 08 99	stone filter media if free from sewage contamination only
<b>19 09</b>	<b>wastes from the preparation of water intended for human consumption or water for industrial use</b>
19 09 02	sludges from water clarification
<b>19 12</b>	<b>wastes from the mechanical treatment of waste (for example sorting, crushing, compacting, pelletising) not otherwise specified</b>
19 12 05	clean glass only
19 12 09	minerals (for example sand, stones)



<b>Table S2.1 Permitted waste types and quantities for aggregate and soil treatment facility</b>	
<b>Maximum quantity</b>	The total quantity of waste accepted at the site for the above activity shall be less than 275,000 tonnes a year. Wastes having any of the following characteristics shall not be accepted: <ul style="list-style-type: none"> <li>• Consisting solely or mainly of dusts, powders or loose fibres</li> <li>• Hazardous wastes</li> <li>• Wastes in liquid form</li> </ul>
<b>Waste code</b>	<b>Description</b>
19 12 12	treated bottom ash including IBA and slag other than that containing dangerous substances only.
<b>19 13</b>	<b>wastes from soil and groundwater remediation</b>
19 13 02	solid wastes from soil remediation other than those mentioned in 19 13 01
19 13 04	sludges from soil remediation other than those mentioned in 19 13 03
<b>20</b>	<b>Municipal wastes (household waste and similar commercial, industrial and institutional wastes) including separately collected fractions</b>
<b>20 01</b>	<b>separately collected fractions (except 15 01)</b>
20 01 02	clean glass only
<b>20 02</b>	<b>Garden and park wastes</b>
20 02 02	soil and stones

<b>Table S2.2 Permitted waste types and quantities for waste transfer station and asbestos storage</b>	
<b>Maximum quantity</b>	The total quantity of waste accepted at the site for the above activity shall be less than 75,000 tonnes a year. Notwithstanding the specification of waste types below, waste shall not be accepted at the site which have any of the following characteristics: <ul style="list-style-type: none"> <li>• Consisting solely or mainly of dusts, powders or loose fibres</li> </ul>
<b>Waste code</b>	<b>Description</b>
<b>01</b>	<b>Wastes resulting from exploration, mining, quarrying, and physical and chemical treatment of minerals</b>
<b>01 01</b>	<b>wastes from mineral excavation</b>
01 01 01	wastes from mineral metalliferous excavation
01 01 02	wastes from mineral non-metalliferous excavation
<b>01 03</b>	<b>wastes from physical and chemical processing of metalliferous minerals</b>
01 03 06	tailings other than those mentioned in 01 03 04 and 01 03 05
01 03 09	red mud from alumina production other than the wastes mentioned in 01 03 07
<b>01 04</b>	<b>wastes from physical and chemical processing of non-metalliferous minerals</b>
01 04 08	waste gravel and crushed rocks other than those mentioned in 01 04 07
01 04 09	waste sand and clays
01 04 11	wastes from potash and rock salt processing other than those mentioned in 01 04 07
01 04 12	tailings and other wastes from washing and cleaning of minerals other than those mentioned in 01 04 07 and 01 04 11

<b>Table S2.2 Permitted waste types and quantities for waste transfer station and asbestos storage</b>	
<b>Maximum quantity</b>	The total quantity of waste accepted at the site for the above activity shall be less than 75,000 tonnes a year. Notwithstanding the specification of waste types below, waste shall not be accepted at the site which have any of the following characteristics:  • Consisting solely or mainly of dusts, powders or loose fibres
<b>Waste code</b>	<b>Description</b>
01 04 13	wastes from stone cutting and sawing other than those mentioned in 01 04 07
<b>02</b>	<b>Wastes from agriculture, horticulture, aquaculture, forestry, hunting and fishing, food preparation and processing</b>
<b>02 01</b>	<b>wastes from agriculture, horticulture, aquaculture, forestry, hunting and fishing</b>
02 01 03	plant-tissue waste
02 01 04	waste plastics (except packaging)
02 01 07	wastes from forestry
02 01 10	waste metal
<b>02 02</b>	<b>wastes from the preparation and processing of meat, fish and other foods of animal origin</b>
02 02 03	materials unsuitable for consumption or processing
<b>02 03</b>	<b>wastes from fruit, vegetables, cereals, edible oils, cocoa, coffee, tea and tobacco preparation and processing; conserve production; yeast and yeast extract production, molasses preparation and fermentation</b>
02 03 04	materials unsuitable for consumption or processing
<b>02 04</b>	<b>wastes from sugar processing</b>
02 04 01	soil from cleaning and washing beet
02 04 02	off-specification calcium carbonate
<b>02 05</b>	<b>wastes from the dairy products industry</b>
02 05 01	materials unsuitable for consumption or processing
<b>02 06</b>	<b>wastes from the baking and confectionery industry</b>
02 06 01	materials unsuitable for consumption or processing
02 06 02	wastes from preserving agents
<b>02 07</b>	<b>wastes from the production of alcoholic and non-alcoholic beverages (except coffee, tea and cocoa)</b>
02 07 01	wastes from washing, cleaning and mechanical reduction of raw materials
02 07 02	wastes from spirits distillation
02 07 04	materials unsuitable for consumption or processing
<b>03</b>	<b>Wastes from wood processing and the production of panels and furniture, pulp, paper and cardboard</b>
<b>03 01</b>	<b>wastes from wood processing and the production of panels and furniture</b>
03 01 01	waste bark and cork
03 01 05	sawdust, shavings, cuttings, wood, particle board and veneer other than those mentioned in 03 01 04
<b>03 03</b>	<b>wastes from pulp, paper and cardboard production and processing</b>

<b>Table S2.2 Permitted waste types and quantities for waste transfer station and asbestos storage</b>	
<b>Maximum quantity</b>	<p>The total quantity of waste accepted at the site for the above activity shall be less than 75,000 tonnes a year.</p> <p>Notwithstanding the specification of waste types below, waste shall not be accepted at the site which have any of the following characteristics:</p> <ul style="list-style-type: none"> <li>• Consisting solely or mainly of dusts, powders or loose fibres</li> </ul>
<b>Waste code</b>	<b>Description</b>
03 03 01	waste bark and wood
03 03 07	mechanically separated rejects from pulping of waste paper and cardboard
03 03 08	wastes from sorting of paper and cardboard destined for recycling
03 03 10	fibre rejects, fibre-, filler- and coating-sludges from mechanical separation
<b>04</b>	<b>Wastes from the leather, fur and textile industries</b>
<b>04 01</b>	<b>wastes from the leather and fur industry</b>
04 01 08	waste tanned leather (blue sheetings, shavings, cuttings, buffing dust) containing chromium
04 01 09	wastes from dressing and finishing
<b>04 02</b>	<b>wastes from the textile industry</b>
04 02 21	wastes from unprocessed textile fibres
04 02 22	wastes from processed textile fibres
<b>06</b>	<b>Wastes from inorganic chemical processes</b>
<b>06 09</b>	<b>wastes from the MSFU of phosphorous chemicals and phosphorous chemical processes</b>
06 09 02	phosphorous slag
06 09 04	calcium-based reaction wastes other than those mentioned in 06 09 03
<b>06 11</b>	<b>wastes from the manufacture of inorganic pigments and opacifiers</b>
06 11 01	calcium-based reaction wastes from titanium dioxide production
<b>07</b>	<b>Wastes from organic chemical processes</b>
<b>07 02</b>	<b>wastes from the MFSU of plastics, synthetic rubber and man-made fibres</b>
07 02 13	waste plastic
<b>09</b>	<b>Wastes from the photographic industry</b>
<b>09 01</b>	<b>wastes from the photographic industry</b>
09 01 07	photographic film and paper containing silver or silver compounds
09 01 08	photographic film and paper free of silver or silver compounds
09 01 10	single-use cameras without batteries
09 01 12	single-use cameras containing batteries other than those mentioned in 09 01 11
<b>10</b>	<b>Wastes from thermal processes</b>
<b>10 01</b>	<b>wastes from power stations and other combustion plants (except 19)</b>
10 01 01	bottom ash, slag and boiler dust (excluding boiler dust mentioned in 10 01 04)
10 01 05	calcium-based reaction wastes from flue-gas desulphurisation in solid form
10 01 07	calcium-based reaction wastes from flue-gas desulphurisation in sludge form

<b>Table S2.2 Permitted waste types and quantities for waste transfer station and asbestos storage</b>	
<b>Maximum quantity</b>	<p>The total quantity of waste accepted at the site for the above activity shall be less than 75,000 tonnes a year.</p> <p>Notwithstanding the specification of waste types below, waste shall not be accepted at the site which have any of the following characteristics:</p> <ul style="list-style-type: none"> <li>• Consisting solely or mainly of dusts, powders or loose fibres</li> </ul>
<b>Waste code</b>	<b>Description</b>
10 01 15	bottom ash, slag and boiler dust from co-incineration other than those mentioned in 10 01 14
10 01 19	wastes from gas cleaning other than those mentioned in 10 01 05, 10 01 07 and 10 01 18
10 01 24	sands from fluidised beds
<b>10 02</b>	<b>wastes from the iron and steel industry</b>
10 02 01	wastes from the processing of slag
10 02 02	unprocessed slag
10 02 08	solid wastes from gas treatment other than those mentioned in 10 02 07
10 02 10	mill scales
10 02 14	filter cakes from gas treatment other than those mentioned in 10 02 13
10 02 15	other filter cakes
<b>10 03</b>	<b>wastes from aluminium thermal metallurgy</b>
10 03 02	anode scraps
10 03 05	waste alumina
10 03 16	skimmings other than those mentioned in 10 03 15
10 03 18	carbon-containing wastes from anode manufacture other than those mentioned in 10 03 17
10 03 24	solid wastes from gas treatment other than those mentioned in 10 03 23
10 03 26	sludges and filter cakes from gas treatment other than those mentioned in 10 03 25
10 03 28	wastes from cooling-water treatment other than those mentioned in 10 03 27
10 03 30	wastes from treatment of salt slags and black drosses other than those mentioned in 10 03 29
<b>10 04</b>	<b>wastes from lead thermal metallurgy</b>
10 04 10	wastes from cooling-water treatment other than those mentioned in 10 04 09
<b>10 05</b>	<b>wastes from zinc thermal metallurgy</b>
10 05 01	slags from primary and secondary production
10 05 09	wastes from cooling-water treatment other than those mentioned in 10 05 08
10 05 11	dross and skimmings other than those mentioned in 10 05 10
<b>10 06</b>	<b>wastes from copper thermal metallurgy</b>
10 06 01	slags from primary and secondary production
10 06 02	dross and skimmings from primary and secondary production
10 06 10	wastes from cooling-water treatment other than those mentioned in 10 06 09
<b>10 07</b>	<b>wastes from silver, gold and platinum thermal metallurgy</b>

<b>Table S2.2 Permitted waste types and quantities for waste transfer station and asbestos storage</b>	
<b>Maximum quantity</b>	<p>The total quantity of waste accepted at the site for the above activity shall be less than 75,000 tonnes a year.</p> <p>Notwithstanding the specification of waste types below, waste shall not be accepted at the site which have any of the following characteristics:</p> <ul style="list-style-type: none"> <li>• Consisting solely or mainly of dusts, powders or loose fibres</li> </ul>
<b>Waste code</b>	<b>Description</b>
10 07 01	slags from primary and secondary production
10 07 02	dross and skimmings from primary and secondary production
10 07 03	solid wastes from gas treatment
10 07 05	filter cakes from gas treatment
10 07 08	wastes from cooling-water treatment other than those mentioned in 10 07 07
<b>10 08</b>	<b>wastes from other non-ferrous thermal metallurgy</b>
10 08 09	other slags
10 08 11	dross and skimmings other than those mentioned in 10 08 10
10 08 13	carbon-containing wastes from anode manufacture other than those mentioned in 10 08 12
10 08 14	anode scrap
10 08 18	filter cakes from flue-gas treatment other than those mentioned in 10 08 17
10 08 20	wastes from cooling-water treatment other than those mentioned in 10 08 19
<b>10 09</b>	<b>wastes from casting of ferrous pieces</b>
10 09 03	furnace slag
10 09 06	casting cores and moulds which have not undergone pouring other than those mentioned in 10 09 05
10 09 08	casting cores and moulds which have undergone pouring other than those mentioned in 10 09 07
10 09 14	waste binders other than those mentioned in 10 09 13
10 09 16	waste crack-indicating agent other than those mentioned in 10 09 15
<b>10 10</b>	<b>wastes from casting of non-ferrous pieces</b>
10 10 03	furnace slag
10 10 06	casting cores and moulds which have not undergone pouring, other than those mentioned in 10 10 05
10 10 08	casting cores and moulds which have undergone pouring, other than those mentioned in 10 10 07
10 10 14	waste binders other than those mentioned in 10 10 13
10 10 16	waste crack-indicating agent other than those mentioned in 10 10 15
<b>10 11</b>	<b>wastes from manufacture of glass and glass products</b>
10 11 03	waste glass-based fibrous materials
10 11 10	waste preparation mixture before thermal processing, other than those mentioned in 10 11 09
10 11 12	waste glass other than those mentioned in 10 11 11
10 11 16	solid wastes from flue-gas treatment other than those mentioned in 10 11 15

<b>Table S2.2 Permitted waste types and quantities for waste transfer station and asbestos storage</b>	
<b>Maximum quantity</b>	<p>The total quantity of waste accepted at the site for the above activity shall be less than 75,000 tonnes a year.</p> <p>Notwithstanding the specification of waste types below, waste shall not be accepted at the site which have any of the following characteristics:</p> <ul style="list-style-type: none"> <li>• Consisting solely or mainly of dusts, powders or loose fibres</li> </ul>
<b>Waste code</b>	<b>Description</b>
10 11 18	filter cakes from flue-gas treatment other than those mentioned in 10 11 17
<b>10 12</b>	<b>wastes from manufacture of ceramic goods, bricks, tiles and construction products</b>
10 12 01	waste preparation mixture before thermal processing
10 12 05	filter cakes from gas treatment
10 12 06	discarded moulds
10 12 08	waste ceramics, bricks, tiles and construction products (after thermal processing)
10 12 10	solid wastes from gas treatment other than those mentioned in 10 12 09
10 12 12	wastes from glazing other than those mentioned in 10 12 11
<b>10 13</b>	<b>wastes from manufacture of cement, lime and plaster and articles and products made from them</b>
10 13 01	waste preparation mixture before thermal processing
10 13 04	wastes from calcination and hydration of lime
10 13 07	filter cakes from gas treatment
10 13 10	wastes from asbestos-cement manufacture other than those mentioned in 10 13 09
10 13 11	wastes from cement-based composite materials other than those mentioned in 10 13 09 and 10 13 10
10 13 13	solid wastes from gas treatment other than those mentioned in 10 13 12
10 13 14	waste concrete
<b>11</b>	<b>Wastes from chemical surface treatment and coating of metals and other materials; non-ferrous hydro-metallurgy</b>
<b>11 01</b>	<b>wastes from chemical surface treatment and coating of metals and other materials (for example galvanic processes, zinc coating processes, pickling processes, etching, phosphatising, alkaline degreasing, anodising)</b>
11 01 10	filter cakes other than those mentioned in 11 01 09
11 01 14	degreasing wastes other than those mentioned in 11 01 13
<b>11 02</b>	<b>wastes from non-ferrous hydrometallurgical processes</b>
11 02 03	wastes from the production of anodes for aqueous electrolytical processes
11 02 06	wastes from copper hydrometallurgical processes other than those mentioned in 11 02 05
<b>11 05</b>	<b>wastes from hot galvanising processes</b>
11 05 01	hard zinc
11 05 02	zinc ash
<b>12</b>	<b>Wastes from shaping and physical and mechanical surface treatment of metals and plastics</b>

<b>Table S2.2 Permitted waste types and quantities for waste transfer station and asbestos storage</b>	
<b>Maximum quantity</b>	<p>The total quantity of waste accepted at the site for the above activity shall be less than 75,000 tonnes a year.</p> <p>Notwithstanding the specification of waste types below, waste shall not be accepted at the site which have any of the following characteristics:</p> <ul style="list-style-type: none"> <li>• Consisting solely or mainly of dusts, powders or loose fibres</li> </ul>
<b>Waste code</b>	<b>Description</b>
<b>12 01</b>	<b>wastes from shaping and physical and mechanical surface treatment of metals and plastics</b>
12 01 01	ferrous metal filings and turnings
12 01 03	non-ferrous metal filings and turnings
12 01 05	plastics shavings and turnings
12 01 13	welding wastes
12 01 17	waste blasting material other than those mentioned in 12 01 16
12 01 21	spent grinding bodies and grinding materials other than those mentioned in 12 01 20
<b>13</b>	<b>Oil wastes and wastes of liquid fuels (except edible oils, and those in chapters 05, 12 and 19)</b>
<b>13 02</b>	<b>waste engine, gear and lubricating oils</b>
13 02 05*	mineral-based non-chlorinated engine, gear and lubricating oils
13 02 06*	synthetic engine, gear and lubricating oils
13 02 07*	readily biodegradable engine, gear and lubricating oils
13 02 08*	other engine, gear and lubricating oils
13 02 10*	Other insulating and heat transmission oils
<b>13 07</b>	<b>wastes of liquid fuels</b>
13 07 01*	fuel oil and diesel
13 07 02*	petrol
<b>15</b>	<b>Waste packaging, absorbents, wiping cloths, filter materials and protective clothing not otherwise specified</b>
<b>15 01</b>	<b>packaging (including separately collected municipal packaging waste)</b>
15 01 01	paper and cardboard packaging
15 01 02	plastic packaging
15 01 03	wooden packaging
15 01 04	metallic packaging
15 01 05	composite packaging
15 01 06	mixed packaging
15 01 07	glass packaging
15 01 09	textile packaging
<b>15 02</b>	<b>absorbents, filter materials, wiping cloths and protective clothing</b>
15 02 03	absorbents, filter materials, wiping cloths and protective clothing other than those mentioned in 15 02 02
<b>16</b>	<b>Wastes not otherwise specified in the list</b>

<b>Table S2.2 Permitted waste types and quantities for waste transfer station and asbestos storage</b>	
<b>Maximum quantity</b>	<p>The total quantity of waste accepted at the site for the above activity shall be less than 75,000 tonnes a year.</p> <p>Notwithstanding the specification of waste types below, waste shall not be accepted at the site which have any of the following characteristics:</p> <ul style="list-style-type: none"> <li>• Consisting solely or mainly of dusts, powders or loose fibres</li> </ul>
<b>Waste code</b>	<b>Description</b>
<b>16 01</b>	<b>end-of-life vehicles from different means of transport (including off-road machinery) and wastes from dismantling of end-of-life vehicles and vehicle maintenance (except 13, 14, 16 06 and 16 08)</b>
16 01 03	end-of-life tyres
16 01 07*	oil filters
16 01 11*	brake pads containing asbestos
16 01 12	brake pads other than those mentioned in 16 01 11
16 01 13*	brake fluids
16 01 14*	antifreeze fluids containing dangerous substances
16 01 15	antifreeze fluids other than those mentioned in 16 01 14
<b>16 02</b>	<b>wastes from electrical and electronic equipment</b>
16 02 14	discarded equipment other than those mentioned in 16 02 09 to 16 02 13
16 02 16	components removed from discarded equipment other than those mentioned in 16 02 15
<b>16 03</b>	<b>off-specification batches and unused products</b>
16 03 04	inorganic wastes other than those mentioned in 16 03 03
16 03 06	organic wastes other than those mentioned in 16 03 05
<b>16 05</b>	<b>gases in pressure containers and discarded chemicals</b>
16 05 04*	gases in pressure containers (including halons) containing dangerous substances
16 05 05	gases in pressure containers other than those mentioned in 16 05 04
<b>16 06</b>	<b>batteries and accumulators</b>
16 06 04	alkaline batteries (except 16 06 03)
16 06 05	other batteries and accumulators
<b>16 11</b>	<b>waste linings and refractories</b>
16 11 02	carbon-based linings and refractories from metallurgical processes other than those mentioned in 16 11 01
16 11 04	other linings and refractories from metallurgical processes other than those mentioned in 16 11 03
16 11 06	linings and refractories from non-metallurgical processes other than those mentioned in 16 11 05
<b>17</b>	<b>Construction and demolition wastes (including excavated soil from contaminated sites)</b>
<b>17 01</b>	<b>concrete, bricks, tiles and ceramics</b>
17 01 01	concrete
17 01 02	bricks
17 01 03	tiles and ceramics



<b>Table S2.2 Permitted waste types and quantities for waste transfer station and asbestos storage</b>	
<b>Maximum quantity</b>	<p>The total quantity of waste accepted at the site for the above activity shall be less than 75,000 tonnes a year.</p> <p>Notwithstanding the specification of waste types below, waste shall not be accepted at the site which have any of the following characteristics:</p> <ul style="list-style-type: none"> <li>• Consisting solely or mainly of dusts, powders or loose fibres</li> </ul>
<b>Waste code</b>	<b>Description</b>
17 01 07	mixtures of concrete, bricks, tiles and ceramics other than those mentioned in 17 01 06
<b>17 02</b>	<b>wood, glass and plastic</b>
17 02 01	wood
17 02 02	glass
17 02 03	plastic
<b>17 03</b>	<b>bituminous mixtures, coal tar and tarred products</b>
17 03 01*	bituminous mixtures containing coal tar
17 03 02	bituminous mixtures other than those mentioned in 17 03 01
17 03 03*	coal tar and tarred products
<b>17 04</b>	<b>metals (including their alloys)</b>
17 04 01	copper, bronze, brass
17 04 02	aluminium
17 04 03	lead
17 04 04	zinc
17 04 05	iron and steel
17 04 06	tin
17 04 07	mixed metals
17 04 11	cables other than those mentioned in 17 04 10
<b>17 05</b>	<b>soil (including excavated soil from contaminated sites), stones and dredging spoil</b>
17 05 04	soil and stones other than those mentioned in 17 05 03
17 05 08	track ballast other than those mentioned in 17 05 07
<b>17 06</b>	<b>insulation materials and asbestos-containing construction materials</b>
17 06 01*	insulation materials containing asbestos
17 06 03*	other insulation materials consisting of or containing dangerous substances
17 06 04	insulation materials other than those mentioned in 17 06 01 and 17 06 03
17 06 05*	construction materials containing asbestos
<b>17 08</b>	<b>gypsum-based construction material</b>
17 08 01*	gypsum-based construction materials contaminated with dangerous substances
17 08 02	gypsum-based construction materials other than those mentioned in 17 08 01
<b>17 09</b>	<b>other construction and demolition wastes</b>
17 09 04	mixed construction and demolition wastes other than those mentioned in 17 09 01, 17 09 02 and 17 09 03

<b>Table S2.2 Permitted waste types and quantities for waste transfer station and asbestos storage</b>	
<b>Maximum quantity</b>	<p>The total quantity of waste accepted at the site for the above activity shall be less than 75,000 tonnes a year.</p> <p>Notwithstanding the specification of waste types below, waste shall not be accepted at the site which have any of the following characteristics:</p> <ul style="list-style-type: none"> <li>• Consisting solely or mainly of dusts, powders or loose fibres</li> </ul>
<b>Waste code</b>	<b>Description</b>
<b>19</b>	<b>Wastes from waste management facilities, off-site waste water treatment plants and the preparation of water intended for human consumption and water for industrial use</b>
<b>19 01</b>	<b>wastes from incineration or pyrolysis of waste</b>
19 01 02	ferrous materials removed from bottom ash
19 01 12	bottom ash and slag other than those mentioned in 19 01 11
19 01 18	pyrolysis wastes other than those mentioned in 19 01 17
19 01 19	sands from fluidised beds
<b>19 02</b>	<b>wastes from physico/chemical treatments of waste (including dechromatation, decyanidation, neutralisation)</b>
19 02 03	premixed wastes composed only of non-hazardous wastes
19 02 10	combustible wastes other than those mentioned in 19 02 08 and 19 02 09
<b>19 04</b>	<b>vitrified waste and wastes from vitrification</b>
19 04 01	vitrified waste
<b>19 05</b>	<b>wastes from aerobic treatment of solid wastes</b>
19 05 01	non-composted fraction of municipal and similar wastes
19 05 02	non-composted fraction of animal and vegetable waste
19 05 03	off-specification compost
<b>19 06</b>	<b>wastes from anaerobic treatment of waste</b>
19 06 99	washed grit only
<b>19 12</b>	<b>wastes from the mechanical treatment of waste (for example sorting, crushing, compacting, pelletising) not otherwise specified</b>
19 12 01	paper and cardboard
19 12 02	ferrous metal
19 12 03	non-ferrous metal
19 12 04	plastic and rubber
19 12 05	glass
19 12 07	wood other than that mentioned in 19 12 06
19 12 08	textiles
19 12 09	minerals (for example sand, stones)
19 12 10	combustible waste (refuse derived fuel)
19 12 11*	other wastes (including mixtures of materials) from mechanical treatment of waste containing batteries
19 12 12	other wastes (including mixtures of materials) from mechanical treatment of wastes other than those mentioned in 19 12 11

<b>Table S2.2 Permitted waste types and quantities for waste transfer station and asbestos storage</b>	
<b>Maximum quantity</b>	<p>The total quantity of waste accepted at the site for the above activity shall be less than 75,000 tonnes a year.</p> <p>Notwithstanding the specification of waste types below, waste shall not be accepted at the site which have any of the following characteristics:</p> <ul style="list-style-type: none"> <li>• Consisting solely or mainly of dusts, powders or loose fibres</li> </ul>
<b>Waste code</b>	<b>Description</b>
<b>19 13</b>	<b>wastes from soil and groundwater remediation</b>
19 13 02	solid wastes from soil remediation other than those mentioned in 19 13 01
<b>20</b>	<b>Municipal wastes (household waste and similar commercial, industrial and institutional wastes) including separately collected fractions</b>
<b>20 01</b>	<b>separately collected fractions (except 15 01)</b>
20 01 01	paper and cardboard
20 01 02	glass
20 01 08	biodegradable kitchen and canteen waste
20 01 10	clothes
20 01 11	textiles
20 01 13*	solvents
20 01 14*	acids
20 01 15*	alkalines
20 01 17*	photochemicals
20 01 19*	pesticides
20 01 21*	fluorescent tubes and other mercury-containing waste
20 01 23*	discarded equipment containing chlorofluorocarbons
20 01 25	edible oil and fat
20 01 26*	oil and fat other than those mentioned in 20 01 25
20 01 27*	paint, inks, adhesives and resins containing dangerous substances
20 01 28	paint, inks, adhesives and resins other than those mentioned in 20 01 27
20 01 29*	detergents containing dangerous substances
20 01 30	detergents other than those mentioned in 20 01 29
20 01 33*	batteries and accumulators included in 16 06 01, 16 06 02 or 16 06 03 and unsorted batteries and accumulators containing these batteries
20 01 34	batteries and accumulators other than those mentioned in 20 01 33
20 01 35*	discarded electrical and electronic equipment other than those mentioned in 20 01 21 and 20 01 23 containing hazardous components ( 6 )
20 01 36	discarded electrical and electronic equipment other than those mentioned in 20 01 21, 20 01 23 and 20 01 35
20 01 37*	wood containing dangerous substances
20 01 38	wood other than that mentioned in 20 01 37
20 01 39	plastics
20 01 40	metals

<b>Table S2.2 Permitted waste types and quantities for waste transfer station and asbestos storage</b>	
<b>Maximum quantity</b>	The total quantity of waste accepted at the site for the above activity shall be less than 75,000 tonnes a year. Notwithstanding the specification of waste types below, waste shall not be accepted at the site which have any of the following characteristics:  • Consisting solely or mainly of dusts, powders or loose fibres
<b>Waste code</b>	<b>Description</b>
20 01 41	wastes from chimney sweeping
<b>20 02</b>	<b>garden and park wastes (including cemetery waste)</b>
20 02 01	biodegradable waste
20 02 02	soil and stones
20 02 03	other non-biodegradable wastes
<b>20 03</b>	<b>other municipal wastes</b>
20 03 01	mixed municipal waste
20 03 02	waste from markets
20 03 03	street-cleaning residues
20 03 07	bulky waste

<b>Table S2.3 Permitted waste types and quantities for open windrow composting</b>	
<b>Maximum quantity</b>	The total quantity of waste accepted at the site for the above activity shall be less than 25,000 tonnes a year.
<b>Waste code</b>	<b>Description</b>
<b>02</b>	<b>Wastes from agriculture, horticulture, aquaculture, forestry, hunting and fishing, food preparation and processing</b>
<b>02 01</b>	<b>wastes from agriculture, horticulture, aquaculture, forestry, hunting and fishing</b>
02 01 03	plant-tissue waste
02 01 04	waste plastics (except packaging)
02 01 07	wastes from forestry
02 01 10	waste metal
<b>02 03</b>	<b>wastes from fruit, vegetables, cereals, edible oils, cocoa, coffee, tea and tobacco preparation and processing; conserve production; yeast and yeast extract production, molasses preparation and fermentation</b>
02 03 04	materials unsuitable for consumption or processing
<b>02 07</b>	<b>wastes from the production of alcoholic and non-alcoholic beverages (except coffee, tea and cocoa)</b>
02 07 01	wastes from washing, cleaning and mechanical reduction of raw materials
02 07 02	wastes from spirits distillation
02 07 04	materials unsuitable for consumption or processing
<b>03</b>	<b>Wastes from wood processing and the production of panels and furniture, pulp, paper and cardboard</b>
<b>03 01</b>	<b>wastes from wood processing and the production of panels and furniture</b>

<b>Table S2.3 Permitted waste types and quantities for open windrow composting</b>	
<b>Maximum quantity</b>	<b>The total quantity of waste accepted at the site for the above activity shall be less than 25,000 tonnes a year.</b>
<b>Waste code</b>	<b>Description</b>
03 01 01	waste bark and cork
03 01 05	sawdust, shavings, cuttings, wood, particle board and veneer other than those mentioned in 03 01 04
<b>03 03</b>	<b>wastes from pulp, paper and cardboard production and processing</b>
03 03 01	waste bark and wood
03 03 10	fibre rejects, fibre-, filler- and coating-sludges from mechanical separation
<b>07</b>	<b>Wastes from organic chemical processes</b>
<b>07 02</b>	<b>wastes from the MFSU of plastics, synthetic rubber and man-made fibres</b>
07 02 13	waste plastic (compostable only)
<b>15</b>	<b>Waste packaging, absorbents, wiping cloths, filter materials and protective clothing not otherwise specified</b>
<b>15 01</b>	<b>packaging (including separately collected municipal packaging waste)</b>
15 01 01	paper and cardboard packaging
15 01 02	plastic packaging
15 01 03	wooden packaging
15 01 04	metallic packaging
15 01 05	composite packaging
15 01 09	textile packaging
<b>17</b>	<b>Construction and demolition wastes (including excavated soil from contaminated sites)</b>
<b>17 02</b>	<b>wood, glass and plastic</b>
17 02 01	wood
<b>19</b>	<b>Wastes from waste management facilities, off-site waste water treatment plants and the preparation of water intended for human consumption and water for industrial use</b>
<b>19 02</b>	<b>wastes from physico/chemical treatments of waste (including dechromatation, decyanidation, neutralisation)</b>
19 02 03	premixed wastes composed only of non-hazardous wastes
<b>19 05</b>	<b>wastes from aerobic treatment of solid wastes</b>
19 05 03	off-specification compost
<b>19 06</b>	<b>wastes from anaerobic treatment of waste</b>
19 06 03	liquor from anaerobic treatment of municipal waste
<b>19 12</b>	<b>wastes from the mechanical treatment of waste (for example sorting, crushing, compacting, pelletising) not otherwise specified</b>
19 12 01	paper and cardboard
19 12 07	wood other than that mentioned in 19 12 06
19 12 12	other wastes (including mixtures of materials) from mechanical treatment of wastes other than those mentioned in 19 12 11
<b>20</b>	<b>Municipal wastes (household waste and similar commercial, industrial and institutional wastes) including separately collected fractions</b>

<b>Table S2.3 Permitted waste types and quantities for open windrow composting</b>	
<b>Maximum quantity</b>	<b>The total quantity of waste accepted at the site for the above activity shall be less than 25,000 tonnes a year.</b>
<b>Waste code</b>	<b>Description</b>
<b>20 01</b>	<b>separately collected fractions (except 15 01)</b>
20 01 01	paper and cardboard
20 01 38	wood other than that mentioned in 20 01 37
20 01 39	Plastics (compostable only)
<b>20 02</b>	<b>garden and park wastes (including cemetery waste)</b>
20 02 01	biodegradable waste
20 02 02	soil and stones

<b>Table S2.4 Permitted waste types and quantities for vehicle depollution and dismantling</b>	
<b>Maximum quantity</b>	<b>The total quantity of waste accepted at the site for the above activity shall be less than 2,500 tonnes a year.</b>
<b>Waste code</b>	<b>Description</b>
<b>16</b>	<b>Wastes not otherwise specified in the list</b>
<b>16 01</b>	<b>end-of-life vehicles from different means of transport (including off-road machinery) and wastes from dismantling of end-of-life vehicles and vehicle maintenance (except 13, 14, 16 06 and 16 08)</b>
16 01 03	end-of-life tyres
16 01 07*	oil filters
16 01 11*	brake pads containing asbestos
16 01 12	brake pads other than those mentioned in 16 01 11
16 01 13*	brake fluids
16 01 14*	antifreeze fluids containing hazardous substances
16 01 15	antifreeze fluids other than those mentioned in 16 01 14

<b>Table S2.5 Permitted waste types and quantities for non-hazardous mechanical biological treatment facility</b>	
<b>Maximum quantity</b>	<b>The total quantity of waste accepted at the site for the above activity shall be less than 75,000 tonnes a year.</b>
<b>Waste code</b>	<b>Description</b>
<b>02</b>	<b>Wastes from agriculture, horticulture, aquaculture, forestry, hunting and fishing, food preparation and processing</b>
<b>02 01</b>	<b>wastes from agriculture, horticulture, aquaculture, forestry, hunting and fishing</b>
02 01 03	plant-tissue waste

<b>Table S2.5 Permitted waste types and quantities for non-hazardous mechanical biological treatment facility</b>	
<b>Maximum quantity</b>	<b>The total quantity of waste accepted at the site for the above activity shall be less than 75,000 tonnes a year.</b>
<b>Waste code</b>	<b>Description</b>
02 01 04	waste plastics (except packaging)
02 01 07	wastes from forestry
<b>02 02</b>	<b>wastes from the preparation and processing of meat, fish and other foods of animal origin</b>
02 02 03	materials unsuitable for consumption or processing
<b>02 03</b>	<b>wastes from fruit, vegetables, cereals, edible oils, cocoa, coffee, tea and tobacco preparation and processing; conserve production; yeast and yeast extract production, molasses preparation and fermentation</b>
02 03 04	materials unsuitable for consumption or processing
<b>02 05</b>	<b>wastes from the dairy products industry</b>
02 05 01	materials unsuitable for consumption or processing
<b>02 07</b>	<b>wastes from the production of alcoholic and non-alcoholic beverages (except coffee, tea and cocoa)</b>
02 07 01	wastes from washing, cleaning and mechanical reduction of raw materials
02 07 02	wastes from spirits distillation
02 07 04	materials unsuitable for consumption or processing
<b>03</b>	<b>Wastes from wood processing and the production of panels and furniture, pulp, paper and cardboard</b>
<b>03 01</b>	<b>wastes from wood processing and the production of panels and furniture</b>
03 01 01	waste bark and cork
03 01 05	sawdust, shavings, cuttings, wood, particle board and veneer other than those mentioned in 03 01 04
<b>03 03</b>	<b>wastes from pulp, paper and cardboard production and processing</b>
03 03 01	waste bark and wood
03 03 07	mechanically separated rejects from pulping of waste paper and cardboard
03 03 08	wastes from sorting of paper and cardboard destined for recycling
03 03 10	fibre rejects, fibre-, filler- and coating-sludges from mechanical separation
<b>04</b>	<b>Wastes from the leather, fur and textile industries</b>
<b>04 01</b>	<b>wastes from the leather and fur industry</b>
04 01 08	waste tanned leather (blue sheetings, shavings, cuttings, buffing dust) containing chromium
04 01 09	wastes from dressing and finishing
<b>04 02</b>	<b>wastes from the textile industry</b>
04 02 21	wastes from unprocessed textile fibres
04 02 22	wastes from processed textile fibres
<b>07</b>	<b>Wastes from organic chemical processes</b>
<b>07 02</b>	<b>wastes from the MFSU of plastics, synthetic rubber and man-made fibres</b>
07 02 13	waste plastic

<b>Table S2.5 Permitted waste types and quantities for non-hazardous mechanical biological treatment facility</b>	
<b>Maximum quantity</b>	<b>The total quantity of waste accepted at the site for the above activity shall be less than 75,000 tonnes a year.</b>
<b>Waste code</b>	<b>Description</b>
<b>15</b>	<b>Waste packaging, absorbents, wiping cloths, filter materials and protective clothing not otherwise specified</b>
<b>15 01</b>	<b>packaging (including separately collected municipal packaging waste)</b>
15 01 01	paper and cardboard packaging
15 01 02	plastic packaging
15 01 03	wooden packaging
15 01 05	composite packaging
15 01 06	mixed packaging
15 01 09	textile packaging
<b>15 02</b>	<b>absorbents, filter materials, wiping cloths and protective clothing</b>
15 02 03	absorbents, filter materials, wiping cloths and protective clothing other than those mentioned in 15 02 02
<b>17</b>	<b>Construction and demolition wastes (including excavated soil from contaminated sites)</b>
<b>17 02</b>	<b>wood, glass and plastic</b>
17 02 01	wood
<b>19</b>	<b>Wastes from waste management facilities, off-site waste water treatment plants and the preparation of water intended for human consumption and water for industrial use</b>
<b>19 02</b>	<b>wastes from physico/chemical treatments of waste (including dechromatation, decyanidation, neutralisation)</b>
19 02 03	premixed wastes composed only of non-hazardous wastes
19 02 10	combustible wastes other than those mentioned in 19 02 08 and 19 02 09
<b>19 05</b>	<b>wastes from aerobic treatment of solid wastes</b>
19 05 01	non-composted fraction of municipal and similar wastes
19 05 02	non-composted fraction of animal and vegetable waste
19 05 03	off-specification compost
<b>19 12</b>	<b>wastes from the mechanical treatment of waste (for example sorting, crushing, compacting, pelletising) not otherwise specified</b>
19 12 01	paper and cardboard
19 12 07	wood other than that mentioned in 19 12 06
19 12 08	textiles
19 12 12	other wastes (including mixtures of materials) from mechanical treatment of wastes other than those mentioned in 19 12 11
<b>20</b>	<b>Municipal wastes (household waste and similar commercial, industrial and institutional wastes) including separately collected fractions</b>
<b>20 01</b>	<b>separately collected fractions (except 15 01)</b>
20 01 01	paper and cardboard
20 01 38	wood other than that mentioned in 20 01 37



<b>Table S2.5 Permitted waste types and quantities for non-hazardous mechanical biological treatment facility</b>	
<b>Maximum quantity</b>	<b>The total quantity of waste accepted at the site for the above activity shall be less than 75,000 tonnes a year.</b>
<b>Waste code</b>	<b>Description</b>
20 01 39	plastics
<b>20 03</b>	<b>other municipal wastes</b>
20 03 01	mixed municipal waste
20 03 02	waste from markets
20 03 03	street-cleaning residues

## Schedule 3 – Emissions and monitoring

<b>Emission point ref. &amp; location</b>	<b>Source</b>	<b>Parameter</b>	<b>Limit (including unit)</b>	<b>Reference period</b>	<b>Monitoring frequency</b>	<b>Monitoring standard or method</b>
Monitoring locations as per Schedule1, Table S1.3, pre-operational conditions for future development, PO2	Outlet from bio-filters emitting treated air from inside buildings and plant.	VOCs	100mg/m <sup>3</sup>	Reference period, monitoring frequency and standard as per Schedule1, Table S1.2, pre-operational conditions for future development, PO2		
		Ammonia	5 mg/m <sup>3</sup>			
		Hydrogen Sulphide	2 mg/m <sup>3</sup>			

<b>Location or description of point of measurement</b>	<b>Parameter</b>	<b>Monitoring frequency</b>	<b>Monitoring standard or method</b>	<b>Other specifications</b>
Monitoring locations as per Schedule1, Table S1.3, pre-operational conditions for future development, PO2	Particulate matter	Continuous	Monitoring standards and other specifications d as per Schedule1, Table S1.2, pre-operational conditions for future development, PO2	
	Odours	Daily		
	Total bacteria	Weekly		
	Total fungi	Weekly		
Internal for each windrow and for any sample of waste or compost	Temperature	--		

## Schedule 4 – Reporting

<b>Table S4.1 Reporting of monitoring data</b>			
<b>Parameter</b>	<b>Emission or monitoring point/reference</b>	<b>Reporting period</b>	<b>Period begins</b>
Emissions to air Parameters as required by condition 3.5.1.	Monitoring locations as per Schedule1, Table S1.3, improvement condition (IC1)	Every 6 months	01/01, 01/07
Ambient air monitoring Parameters as required by condition 3.5.1	Monitoring locations as per Schedule1, Table S1.3, improvement condition (IC1)	Every 6 months	01/01, 01/07

# Schedule 5 – Notification

These pages outline the information that the operator must provide.

Units of measurement used in information supplied under Part A and B requirements shall be appropriate to the circumstances of the emission. Where appropriate, a comparison should be made of actual emissions and authorised emission limits.

If any information is considered commercially confidential, it should be separated from non-confidential information, supplied on a separate sheet and accompanied by an application for commercial confidentiality under the provisions of the EP Regulations.

## Part A

Permit Number	
Name of operator	
Location of Facility	
Time and date of the detection	

<b>(a) Notification requirements for any malfunction, breakdown or failure of equipment or techniques, accident, or emission of a substance not controlled by an emission limit which has caused, is causing or may cause significant pollution</b>	
<b>To be notified within 24 hours of detection</b>	
Date and time of the event	
Reference or description of the location of the event	
Description of where any release into the environment took place	
Substances(s) potentially released	
Best estimate of the quantity or rate of release of substances	
Measures taken, or intended to be taken, to stop any emission	
Description of the failure or accident.	

<b>(b) Notification requirements for the breach of a limit</b>	
<b>To be notified within 24 hours of detection unless otherwise specified below</b>	
Emission point reference/ source	
Parameter(s)	
Limit	
Measured value and uncertainty	
Date and time of monitoring	

<b>(b) Notification requirements for the breach of a limit</b>	
<b>To be notified within 24 hours of detection unless otherwise specified below</b>	
Measures taken, or intended to be taken, to stop the emission	

<b>Time periods for notification following detection of a breach of a limit</b>	
<b>Parameter</b>	<b>Notification period</b>

<b>(c) Notification requirements for the detection of any significant adverse environmental effect</b>	
<b>To be notified within 24 hours of detection</b>	
Description of where the effect on the environment was detected	
Substances(s) detected	
Concentrations of substances detected	
Date of monitoring/sampling	

## Part B – to be submitted as soon as practicable

Any more accurate information on the matters for notification under Part A.	
Measures taken, or intended to be taken, to prevent a recurrence of the incident	
Measures taken, or intended to be taken, to rectify, limit or prevent any pollution of the environment which has been or may be caused by the emission	
The dates of any unauthorised emissions from the facility in the preceding 24 months.	

<b>Name*</b>	
<b>Post</b>	
<b>Signature</b>	
<b>Date</b>	

\* authorised to sign on behalf of the operator

## Schedule 6 – Interpretation

“accident” means an accident that may result in pollution.

“Annex I” means Annex I to Directive 2008/98/EC of the European Parliament and of the Council on waste.

“Annex II” means Annex II to Directive 2008/98/EC of the European Parliament and of the Council on waste.

“application” means the application for this permit, together with any additional information supplied by the operator as part of the application and any response to a notice served under Schedule 5 to the EP Regulations.

“authorised officer” means any person authorised by the Environment Agency under section 108(1) of The Environment Act 1995 to exercise, in accordance with the terms of any such authorisation, any power specified in section 108(4) of that Act.

“building” means a construction that has the objective of providing sheltering cover and minimising emissions of noise, particulate matter, odour and litter.

“D” means a disposal operation provided for in Annex I to Directive 2008/98/EC of the European Parliament and of the Council on waste.

“emissions to land” includes emissions to groundwater.

“emissions of substances not controlled by emission limits” means emissions of substances to air, water or land from the activities, either from the emission points specified in schedule 3 or from other localised or diffuse sources, which are not controlled by an emission limit.

“EP Regulations” means The Environmental Permitting (England and Wales) Regulations SI 2016 No.1154 and words and expressions used in this permit which are also used in the Regulations have the same meanings as in those Regulations.

“groundwater” means all water, which is below the surface of the ground in the saturation zone and in direct contact with the ground or subsoil.

“groundwater protection zones 1 and 2” have the meaning given in the document titled "Groundwater Protection: Policy and Practice" published by the Environment Agency in 2006.

“Hazardous property” has the meaning in Annex III of the Waste Framework Directive.

“Hazardous waste” has the meaning given in the Hazardous Waste (England and Wales) Regulations 2005.

“List of Wastes” means the list of wastes established by Commission Decision 2000/532/EC replacing Decision 94/3/EC establishing a list of wastes pursuant to Article 1(a) of Council Directive 75/442/EEC on waste and Council Decision 94/904/EC establishing a list of hazardous waste pursuant to Article 1(4) of Council Directive 91/689/EEC on hazardous waste.

“pests” means birds, vermin and insects.

“R” means a recovery operation provided for in Annex II to Directive 2008/98/EC of the European Parliament and of the Council on waste.

“Waste code” means the six digit code referable to a type of waste in accordance with the List of Wastes and in relation to hazardous waste, includes the asterisk.

“Waste Framework Directive” or “WFD” means Waste Framework Directive 2008/98/EC of the European Parliament and of the Council on waste.

“year” means calendar year ending 31 December.

When the following terms appear in the waste code list in Schedule 2, table S2.1, S2.2, S2.3, S2.4 and S2.5, for those tables, they have the meaning given below:

“hazardous substance” means a substance classified as hazardous as a consequence of fulfilling the criteria laid down in parts 2 to 5 of Annex I to Regulation (EC) No 1272/2008.

“heavy metal” means any compound of antimony, arsenic, cadmium, chromium (VI), copper, lead, mercury, nickel, selenium, tellurium, thallium and tin, as well as these materials in metallic form, as far as these are classified as hazardous substances.

“PCBs” means

- polychlorinated biphenyls
- polychlorinated terphenyls
- monomethyl-tetrachlorodiphenyl methane, Monomethyl-dichloro-diphenyl methane, Monomethyldibromo-diphenyl methane
- any mixture containing any of the above mentioned substances in a total of more than 0,005 %by weight.

“transition metals” means any of the following metals: any compound of scandium, vanadium, manganese, cobalt, copper, yttrium, niobium, hafnium, tungsten, titanium, chromium, iron, nickel, zinc, zirconium, molybdenum and tantalum, as well as these materials in metallic form, as far as these are classified as hazardous substances.

“stabilisation” means processes which change the hazardousness of the constituents in the waste and transform hazardous waste into non-hazardous waste.

“solidification” means processes which only change the physical state of the waste by using additives without changing the chemical properties of the waste.

“partly stabilised wastes” means wastes containing, after the stabilisation process, hazardous constituents which have not been changed completely into non-hazardous constituents and could be released into the environment in the short, middle or long term.

# Schedule 7 – Site plan

Figure S7.1 – Site boundary plan

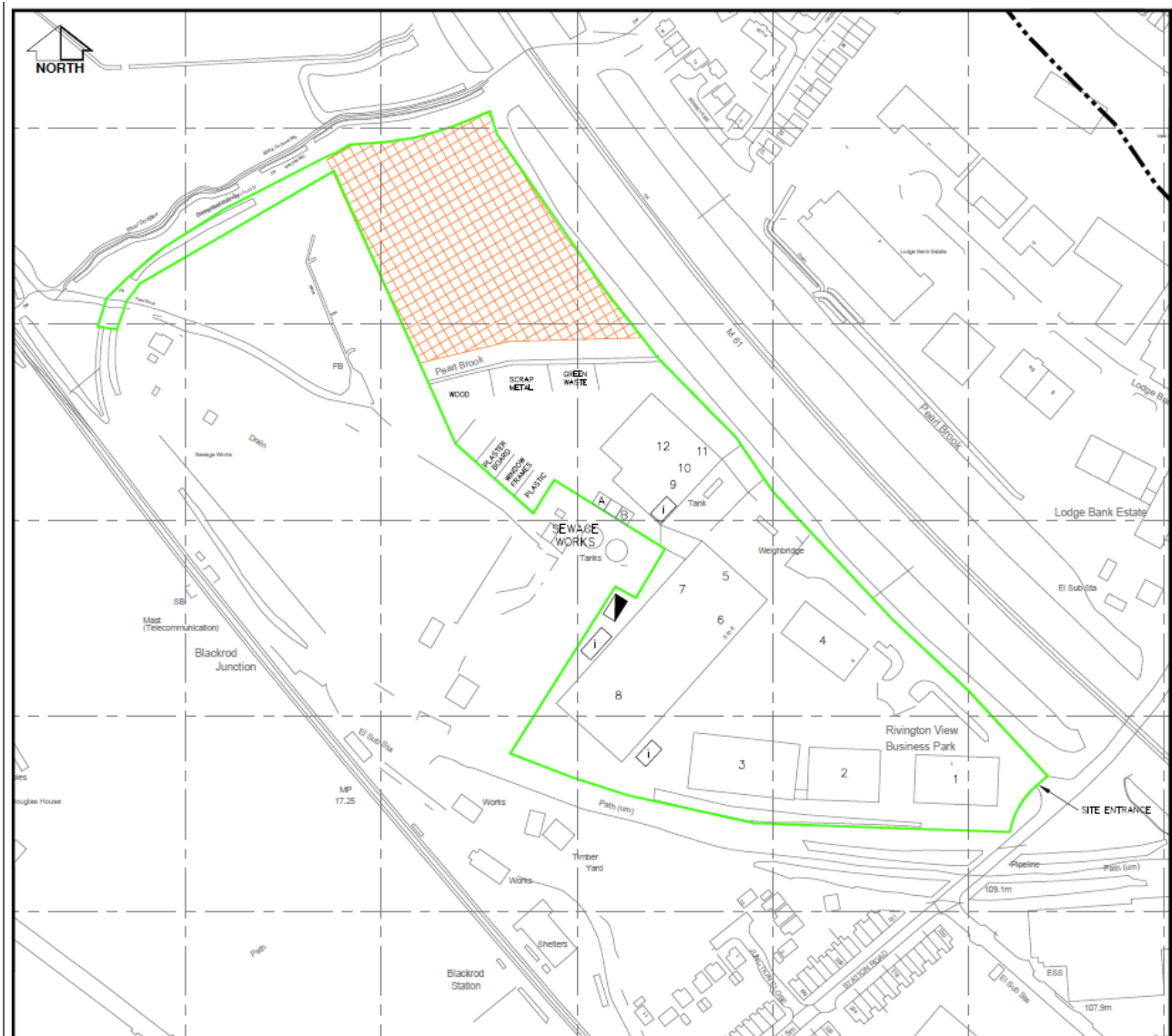

©Crown Copyright. All rights reserved. Environment Agency, 100024198, 2020.

END OF PERMIT